

## Solshield DPC Fixing Strip & Pins

### Solshield DPC Fixing Strip

A black flexible plastic strip, 25mm wide x 2m long. The strip is pre-drilled at approximately 150mm centres providing 12 holes per strip. The product is used to surface fix Solcourse DPC Cavity Trays to the inner leaf of cavity wall constructions, or Solco Membrane's where a surface fixing is required.

#### Benefits

- Adaptable for attachment to various substrates
- Will not corrode
- Flexible and easy to cut
- Part of the BBA approved Solcourse DPC Cavity Tray Systems

### Solcourse DPC Fixing Pins for Insulation (Pic1)

A black plastic, fir-tree, push-fit fixing pin. The product is used in conjunction with Solcourse DPC Fixing Strips for securing surface fixed Solcourse DPC Cavity Trays, or Solco Membranes to the rigid Insulation foam and structural framing systems in cavity wall constructions.

#### Benefits

- Quick and easy to install
- Secure and robust fixing method
- Will not corrode
- Part of the BBA approved Solcourse DPC Cavity Tray Systems

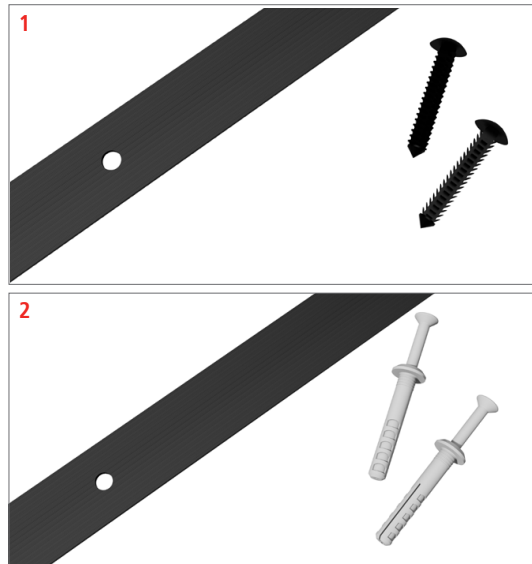

### Solcourse DPC Fixing Pins for Masonry 2 (Pic2)

A grey plastic fixing pin with a central nail. Hammering the central nail into the body of the fixing expands the fixing securing it in the pre-drilled hole. The product is used in conjunction with Solcourse Fixing Strips to secure surface fixed Solcourse DPC Cavity Trays to the masonry inner leaves of cavity wall constructions (e.g. blockwork, cast concrete, etc). When used in conjunction with Solcourse DPC Fixing Strips, the product can also be used to secure Solcourse membrane products where surface fixing is required to masonry surfaces.

#### Benefits

- Secure and robust fixing method
- Will not corrode
- Part of the BBA approved Solcourse DPC Cavity Tray Systems

### Product Details

Product Code	Product Description
S80701050	Solcourse DPC Fixing Strip (pack of 20 x 2m strips)
S80701055	Solcourse DPC Fixing Pins for Insulation (pack of 100)
W10208043	Solcourse DPC Fixing Pins for Masonry (pack of 100)